



Norfolk Street | Lancaster

£120,000



**lunevalley**  
ESTATES.



*scan me to view online!*





This property could not be a more perfect first home or an equally excellent investment opportunity!

Located just outside of Lancaster City Centre, Norfolk street provides the perfect base for young families or professionals. With plenty of amenities within walking distance, and easy access to popular local spots such as Ryelands Park and the River Lune Aqueduct, this truly could be your ideal family home.

Lancaster boasts a number of excellent schools, with St Joseph's Primary 3 minutes walk, Ryelands Primary School & Nursery 15 minutes away, and Our Lady's Catholic College just a 10 minute walk from the property.



A cosy lounge space greets you upon entry to the home, with direct access through to the generous kitchen, where units line one wall and the first staircase provides a perfect understair space - get those clever storage solutions ready!

Upstairs, the gorgeous master bedroom, currently finished in a royal blue and filled with natural light via a large window to the rear. Just a few steps away, the unique bathroom, which hosts a cast iron bath with shower attachment, WC, and hand wash basin. The shape of this room also offers a perfect laundry space upon entry.

The top floor boasts two good size bedrooms, perfect for families with younger children. Both bedrooms are filled with light by the overhead skylights, and offer plenty of floorspace for storage and entertainment.









## Living Room

A cosy lounge area found upon entry to the property, with direct access to the kitchen.

## Kitchen

A great size kitchen, lined with kitchen units and providing plenty of storage options including under-stair solutions. Access to the rear courtyard via back door and staircase leading to first and second floors.

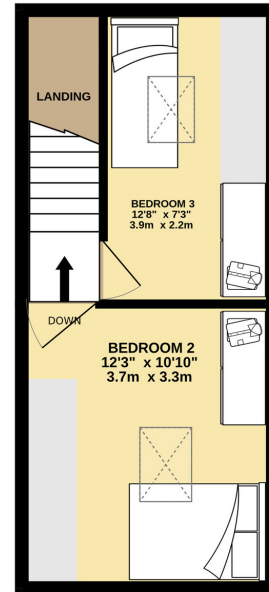
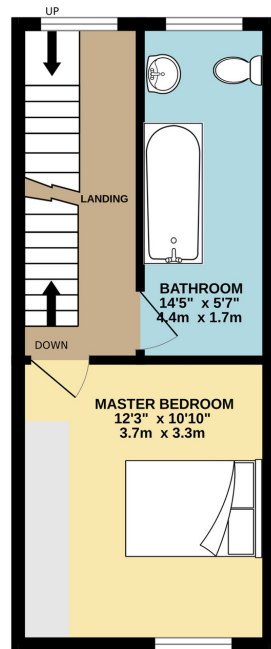
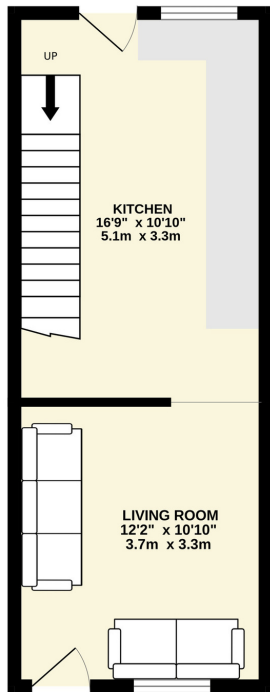

**lunevalley**  
ESTATES.

## Bathroom

A uniquely-shaped three-piece suite, consisting of a classic cast iron bathtub (with overhead shower attachment and privacy glass), a WC and hand wash basin.

## Bedroom One

A gorgeous master bedroom of a good size, with plenty of room for clothes storage and vanity, and lit by a large window overlooking the rear of the property.

## Bedroom Three

A cosy loft room with overhead skylight, currently holding a single bed, desk space and wardrobes.

## Bedroom Two

A good size loft room, featuring a large skylight, and with plenty of space for a double bed, clothing storage, and entertainment systems - perfect for teenagers!

# The Essentials



The New Melbourne  
*0.4 miles*



Convenience  
Express  
*0.1 miles*



Millstone Chippy  
*0.3 miles*



Cohens Chemist  
*0.1 miles*

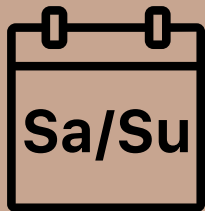

Ryelands Park  
*0.4 miles*

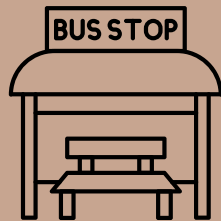

Aldrens Lane  
*0.1 miles*





# lunevalley

## ESTATES.



*Scan to visit our website!*

Suite 8, Willow Mill, Caton, LA2 9RA  
01524 256625  
[team@lunevalleyestates.com](mailto:team@lunevalleyestates.com)  
[lunevalleyestates.com](http://lunevalleyestates.com)