



Hornby Hall Close | Hornby







3 

2 

2 

 **lunevalley**  
ESTATES.



EPC - D



Band E



Freehold







Welcome to your dream home on Hornby Hall Close! Nestled in a serene neighbourhood, this exquisite 2/3 bedroom detached bungalow offers the perfect blend of tranquility and the potential to create an even more beautiful property are endless.



As you step into the incredibly spacious living room, you'll be captivated by its sheer size, providing a versatile space for relaxation and entertainment. Natural light floods the room, creating a warm and inviting atmosphere. Whether you envision cozy family gatherings or vibrant social events, this living room is the heart of your new home.





The modern kitchen is a culinary haven, equipped with state-of-the-art appliances and ample counter space. Prepare delicious meals with ease and enjoy the seamless flow into the adjacent utility room, providing practicality and convenience for your everyday tasks.

There are two incredibly well proportioned double bedrooms along with a third room that was previously utilised as a Garden Room however would make an incredible Master Suite with views over the rear garden and double french doors.

Venture outside to discover the expansive south facing garden, a haven for outdoor enthusiasts. Imagine hosting summer barbecues, gardening, or simply unwinding in the fresh air. The possibilities are endless in this vast outdoor space that offers both privacy and serenity.

The property comes complete with an integral garage and a convenient driveway, ensuring ample parking for you and your guests. Experience the luxury of pulling into your own garage or having the ease of parking just steps away from your front door.

Located on Hornby Hall Close, this bungalow enjoys a peaceful and well-established neighborhood. The surrounding area boasts a sense of community, while still being in close proximity to essential amenities, schools, and recreational facilities. This 2/3 bedroom detached bungalow is not just a home; it's a lifestyle. Immerse yourself in comfort, style, and the joys of suburban living. Don't miss the opportunity to make this property your own and embark on a new chapter of luxury and convenience. Schedule a viewing today and let Hornby Hall Close be the address where your dreams come to life.









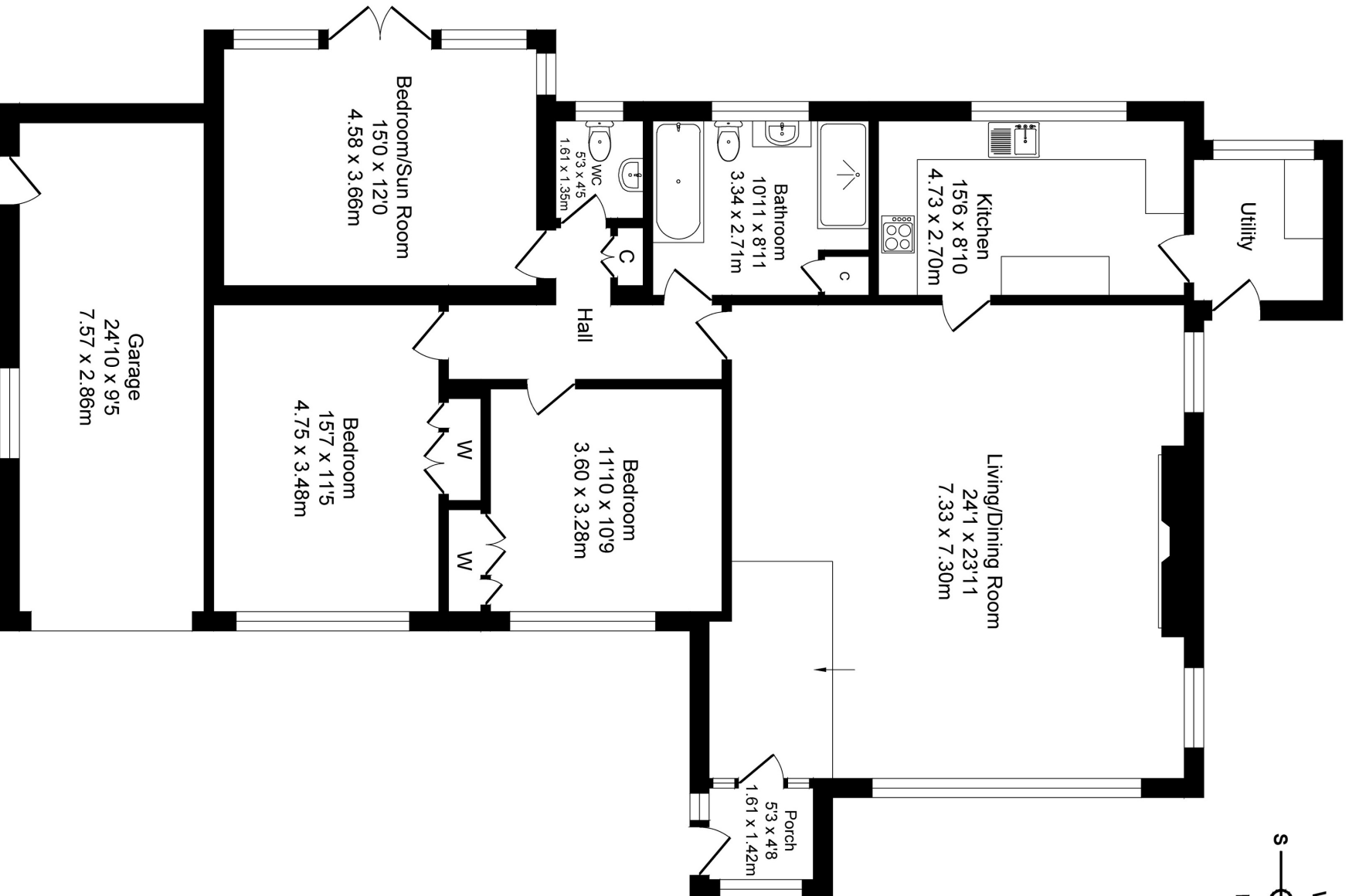
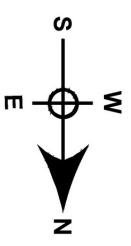

## Hornby Hall Close Hornby

Total Approx. Floor Area 1813 Sq.ft. (168.4 Sq.M.)



# The Essentials



The Royal Oak  
*0.08 miles*



Londis  
*0.3 miles*



The Fenwick  
*1.8 miles*



Boots  
Pharmacy  
*4.4 miles*







# lunevalley

## ESTATES.



*Scan to visit our website!*

Suite 8, Willow Mill, Caton, LA2 9RA  
01524 256625  
[team@lunevalleyestates.com](mailto:team@lunevalleyestates.com)  
[lunevalleyestates.com](http://lunevalleyestates.com)